

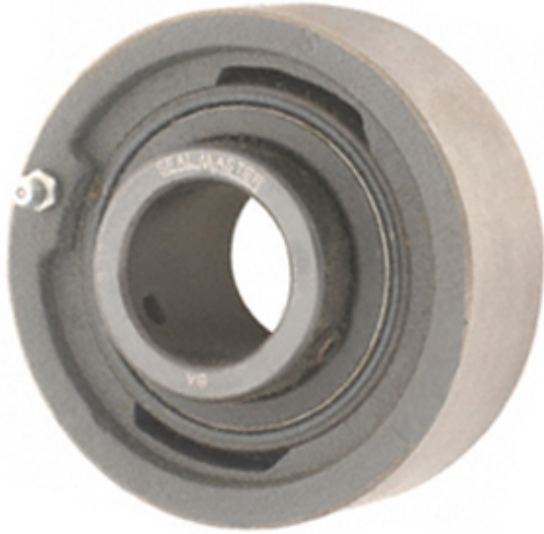

TRUF BEARINGS LIMITED



MSC-316 Bearing 2D drawings and 3D CAD models

SEALMASTER MSC-316 Cartridge Unit Bearings

Bearing No. MSC-316

Category	Cartridge Unit Bearings
Inventory	0.0
Manufacturer Name	REGAL BELOIT
Minimum Buy Quantity	N/A
Weight	9.171
EAN	0662461053607
Product Group	M06110
Mounting Method	Set Screw
Housing Style	Cartridge Unit
Housing Material	Cast Iron
Rolling Element	Ball Bearing
Expansion / Non-expansion	Non-expansion
Relubricatable	Yes
Insert Part Number	5316
Seals	Felt Labyrinth
Other Features	Single Row Medium Duty
Long Description	80MM Bore; 188.91MM Outside Diameter; 63.5MM Cartridge Housing Width; Set Screw; Cartridge Unit; Cast Iron; Ball Bearing; 85.7MM Length Thru Bore; Relubricatable; 5316 Insert; Felt Labyrinth; Non-expa
Inch - Metric	Metric
Category	Mounted Cartridge Units
UNSPSC	31171535
Harmonized Tariff Code	8483.20.40.40



TRUF BEARINGS LIMITED

Noun	Bearing
Keyword String	Cartridge
Manufacturer URL	http://www.emersonindustrial.com
Manufacturer Item Number	MSC-316
Manufacturer Internal Number	710169
Weight / LBS	20.2
D	3.374 Inch 85.7 Millimeter
D	7.438 Inch 188.91 Millimeter
Cartridge Housing Width	2.5 Inch 63.5 Millimeter
d	3.15 Inch 80 Millimeter